

2-COLOR  
"IceStone" LOGO  
(FRONT ONLY)

ALL EXPOSED  
SURFACES ARE  
BLACK MELAMINE

ALL EXPOSED  
EDGES WITH  
PVC  
EDGE-BANDING

CLEAR PLASTIC  
SIGN "FOLDS"

1"X2-1/2"  
METAL TAG  
PLATES ALL  
SHELVES

20 SAMPLES

WIRE LIT POCKET  
ALL BLACK  
FOR 6X6

ALL VERTICAL  
CORNERS WITH  
BLACK PLASTIC  
CORNER PROTECTERS

ALL 5/8"  
THICK  
MDF

SWIVEL CASTERS  
INSIDE BASE

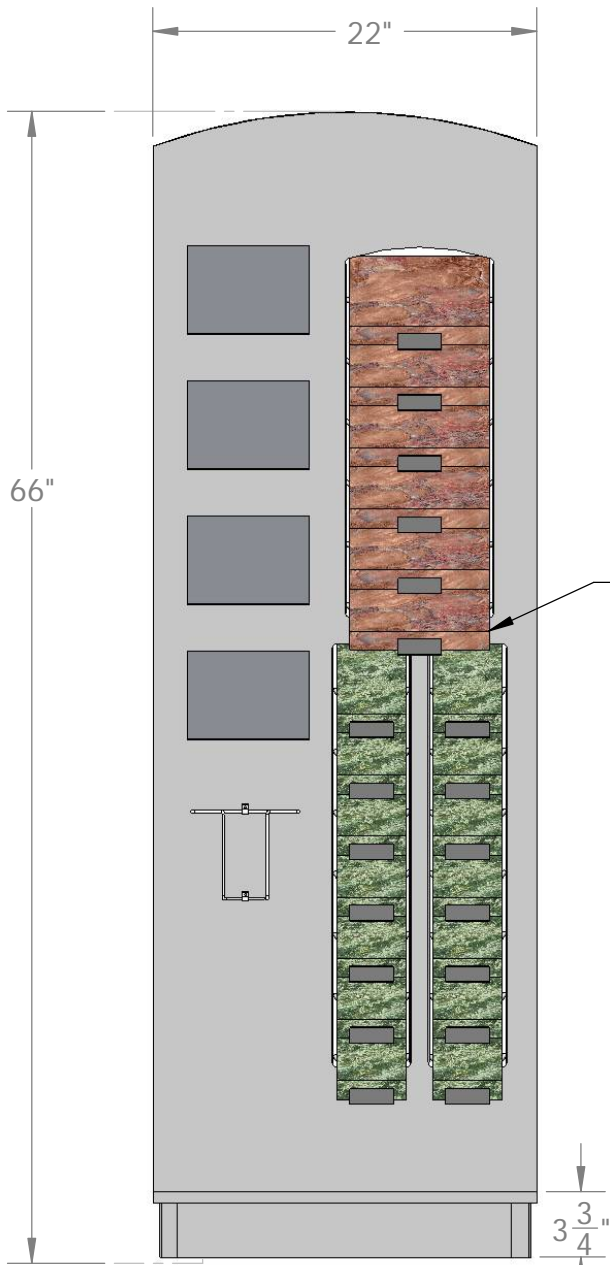

SWIVEL  
CASTERS

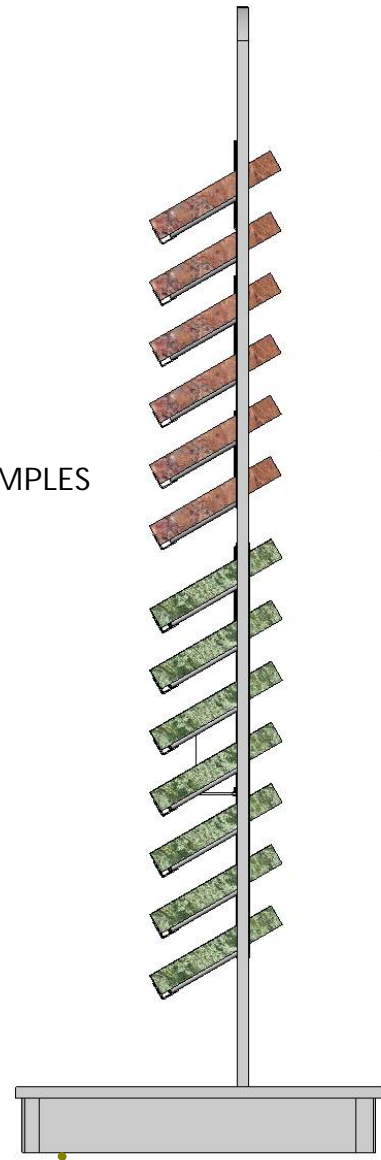

2 COLOR SILK  
SCREENED  
"IceStone"  
LOGO FRONT  
ONLY

ALL EXPOSED  
SURFACES ARE  
BLACK MELAMINE

1"X2-1/2"  
METAL TAG  
PLATES ALL  
SHELVES  
THICK  
MDF

CLEAR PLASTIC  
SIGN "FOLDS"

WIRE LIT POCKET  
ALL BLACK  
FOR 6X6

ALL EXPOSED  
EDGES WITH  
PVC  
EDGE-BANDING

PANEL SLIDES  
DOWN INTO  
BASE (NO  
TOOLS OR  
EXTRA PIECES)

PLASTIC CORNER  
PROTECTORS ALL  
4 CORNERS

# 5X7 PLASTIC SIGN RECEIVER PANELS

DOUBLE FACED TAPE ON BACK



CLEAR  
PLASTIC  
DISPLAY  
PANELS

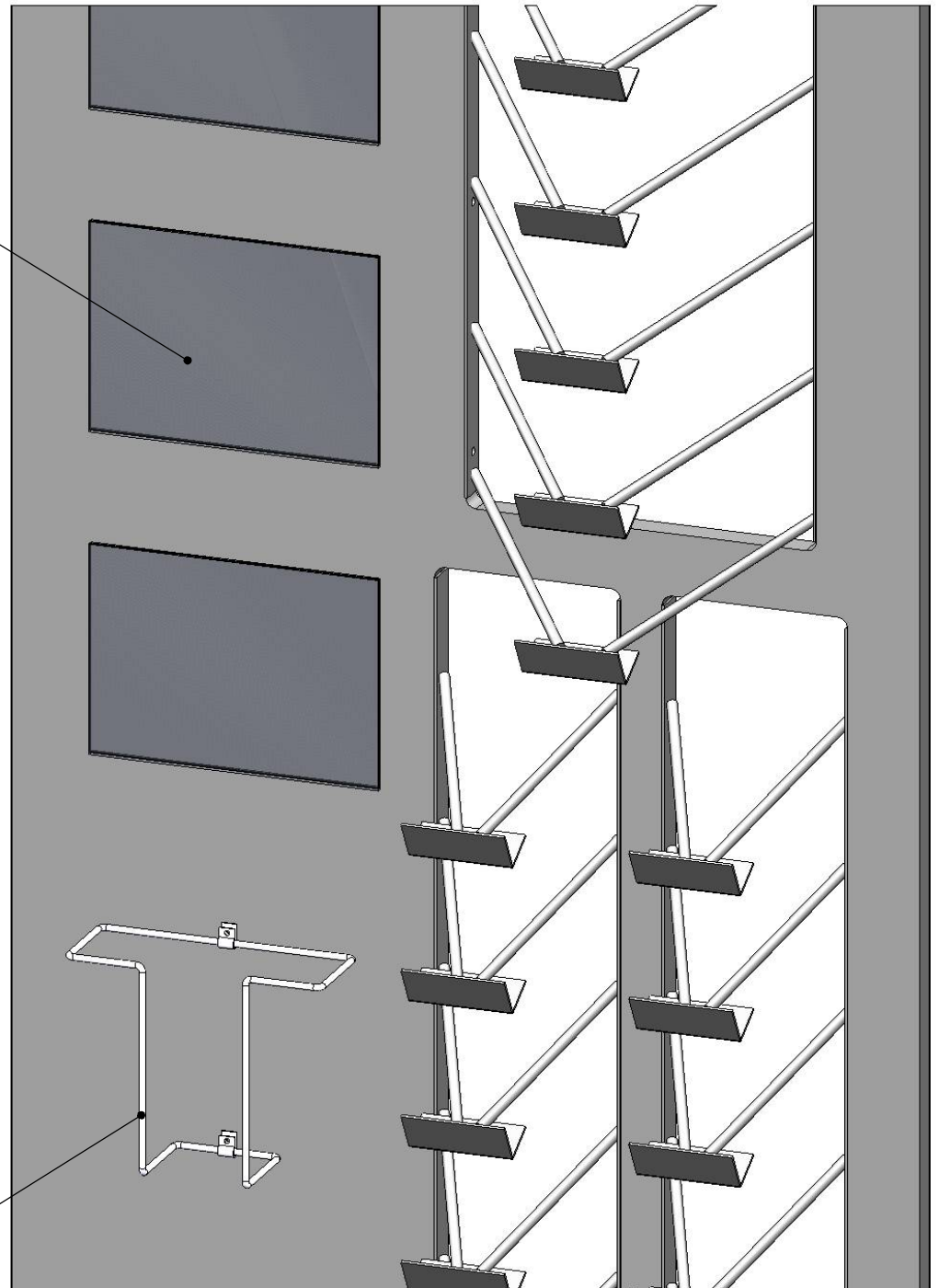

WIRE LITERATURE POCKET  
BLACK TO MATCH DISPLAY



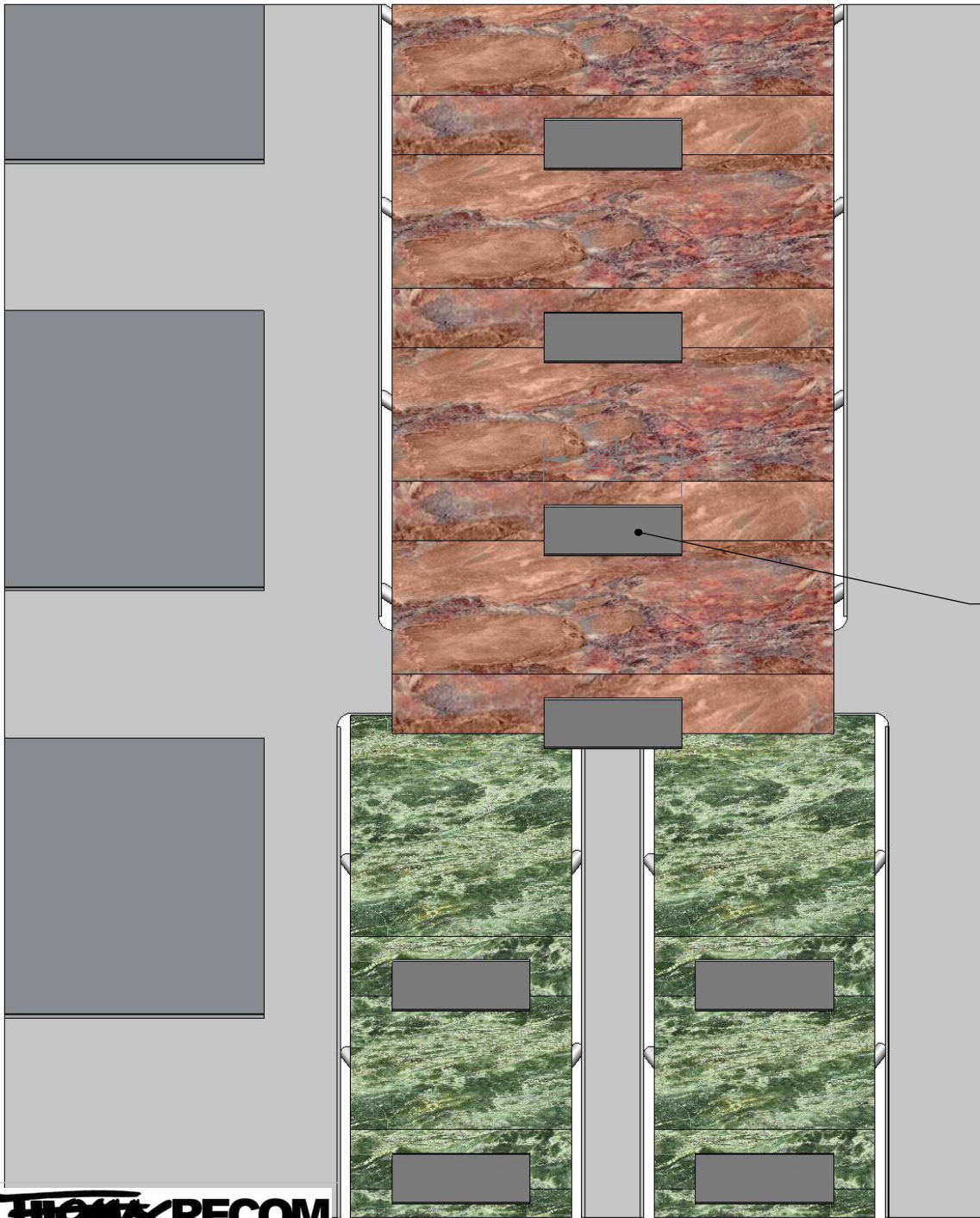

1"X2-1/2"  
TAG PLATE

